



2016 - 2017 | Boat Definitions

LAGOON 380

TRIM

HELM

Triton² Instrument Display



Triton Pilot Controller



Triton² Instrument Display



DST800 Speed/Depth/Temp Transducer



508 Wind Sensor



Autopilot System

RF25 Rudder Feedback



Precision-9

Drive LS 40ST16 (from yard)



AC42 Pilot computer



LAGOON 380 / OPTIONS

OPTIONAL WIFI

WIFI-1™: Wireless Module

- Free "GoFree" application to view/control the MFD available from web



Ethernet

OPTIONAL VHF

V50 VHF Radio

- includes AIS receiver



OPTIONAL VHF 2ND UNIT

H50 Wireless Handset



OPTIONAL AIS

NAIS400 AIS Transponder



OPTIONS



OPTIONAL RADAR

Broadband Radar 4G



Ethernet

OPTIONAL REMOTE

WR10 Wireless Autopilot Remote



OPTIONAL MFD - CHART

Zeus² 12" wide

- 12" LED Multifunction Colour/ Touch display
- Navionics regional cartography included (on SDcard)
- Integrated Pilot control (optional)



OPTIONAL MFD - HELM

Zeus² 9" wide

- 9" LED Multifunction Colour/ Touch display
- Navionics regional cartography included (on SDcard)
- Integrated Pilot control (optional)



OPTIONAL ZEUS MODULES

SonarHub™

ForwardScan®



Ethernet

FORWARDSCAN®



LAGOON 39

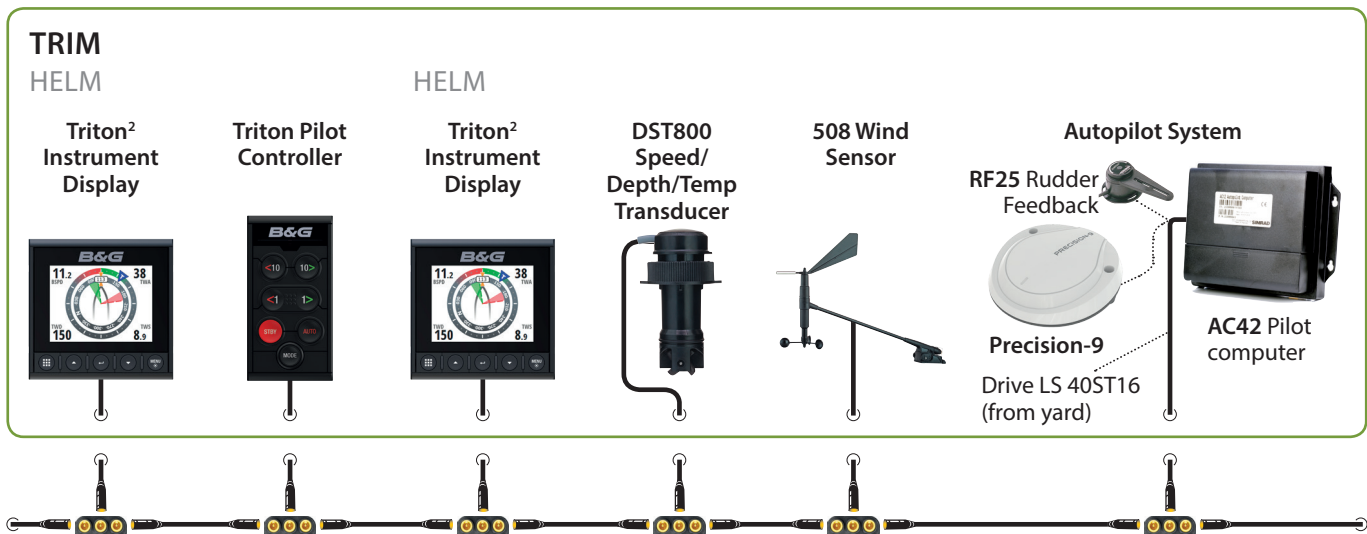

LAGOON 39 / OPTIONS

OPTIONAL WIFI

WIFI-1™: Wireless Module
 • Free "GoFree" application to view/control the MFD available from web



OPTIONAL VHF

V50 VHF Radio
 • includes AIS receiver



OPTIONAL VHF 2ND UNIT

H50 Wireless Handset



OPTIONAL AIS

NAIS400 AIS Transponder



OPTIONS



OPTIONAL RADAR

Broadband Radar 4G



OPTIONAL REMOTE

WR10 Wireless Autopilot Remote



OPTIONAL MFD - CHART

Zeus² 12" wide
 • 12" LED Multifunction Colour/ Touch display
 • Navionics regional cartography included (on SDcard)
 • Integrated Pilot control (optional)



OPTIONAL MFD - HELM

Zeus² 12" wide
 • 12" LED Multifunction Colour/ Touch display
 • Navionics regional cartography included (on SDcard)
 • Integrated Pilot control (optional)



OPTIONAL ZEUS MODULES

SonarHub™

ForwardScan®



LAGOON 400

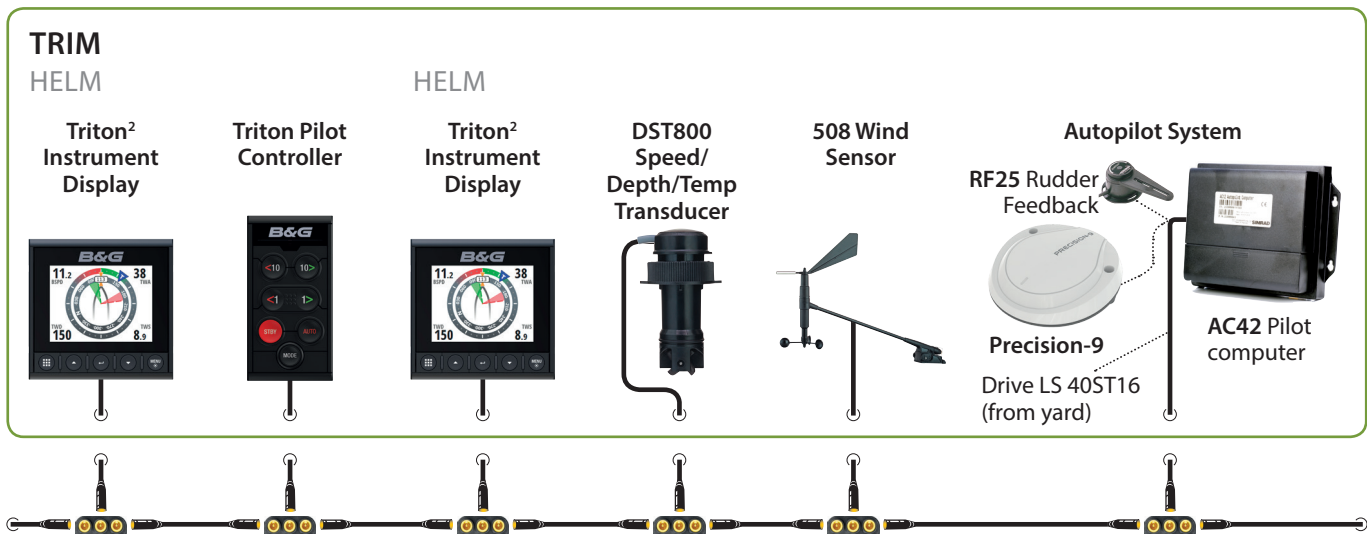

LAGOON 400 / OPTIONS

OPTIONAL WIFI

WIFI-1™: Wireless Module
 • Free "GoFree" application to view/control the MFD available from web



OPTIONAL VHF

V50 VHF Radio
 • includes AIS receiver



OPTIONAL VHF 2ND UNIT

H50 Wireless Handset



OPTIONAL AIS

NAIS400 AIS Transponder



OPTIONS



OPTIONAL RADAR

Broadband Radar 4G



OPTIONAL REMOTE

WR10 Wireless Autopilot Remote



OPTIONAL MFD - CHART

Zeus² 12" wide
 • 12" LED Multifunction Colour/ Touch display
 • Navionics regional cartography included (on SDcard)
 • Integrated Pilot control (optional)



OPTIONAL MFD - HELM

Zeus² 12" wide
 • 12" LED Multifunction Colour/ Touch display
 • Navionics regional cartography included (on SDcard)
 • Integrated Pilot control (optional)



OPTIONAL ZEUS MODULES

SonarHub™

ForwardScan®



LAGOON 42

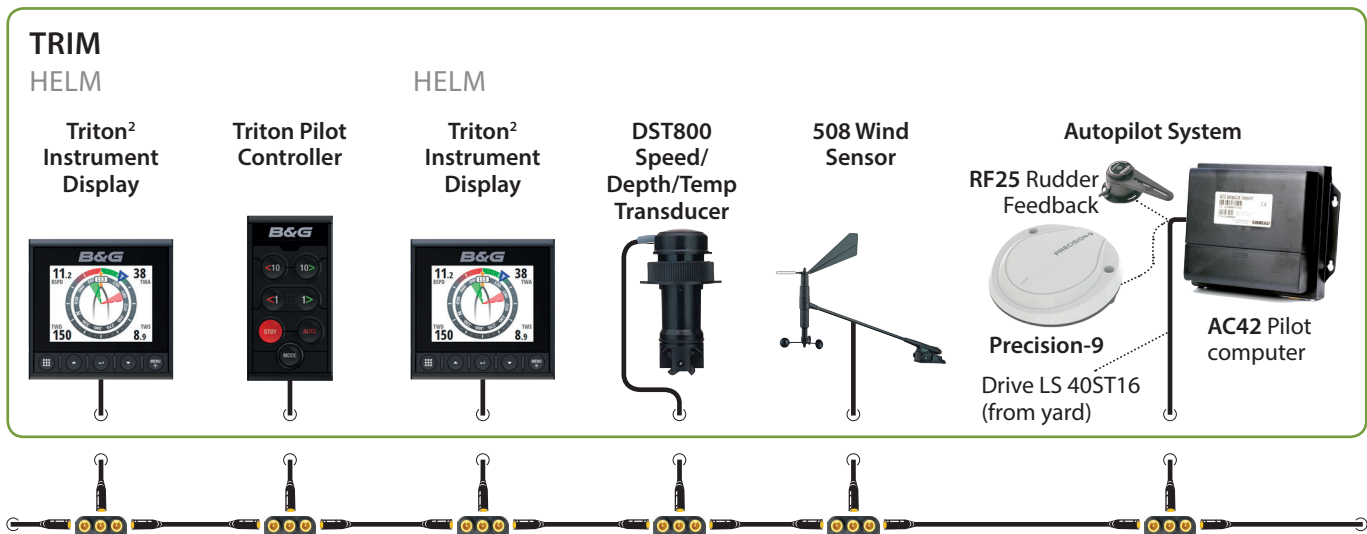

LAGOON 42 / OPTIONS

OPTIONAL WIFI

WIFI-1™: Wireless Module
 • Free "GoFree" application to view/control the MFD available from web



OPTIONAL VHF

V50 VHF Radio
 • includes AIS receiver



OPTIONAL VHF 2ND UNIT

H50 Wireless Handset



OPTIONAL AIS

NAIS400 AIS Transponder



OPTIONS



OPTIONAL RADAR

Broadband Radar 4G



OPTIONAL REMOTE

WR10 Wireless Autopilot Remote



OPTIONAL MFD - CHART

Zeus² 12" wide
 • 12" LED Multifunction Colour/ Touch display
 • Navionics regional cartography included (on SDcard)
 • Integrated Pilot control (optional)



OPTIONAL MFD - HELM

Zeus² 12" wide
 • 12" LED Multifunction Colour/ Touch display
 • Navionics regional cartography included (on SDcard)
 • Integrated Pilot control (optional)



OPTIONAL ZEUS MODULES

SonarHub™

ForwardScan®



LAGOON 450 SPORTOP

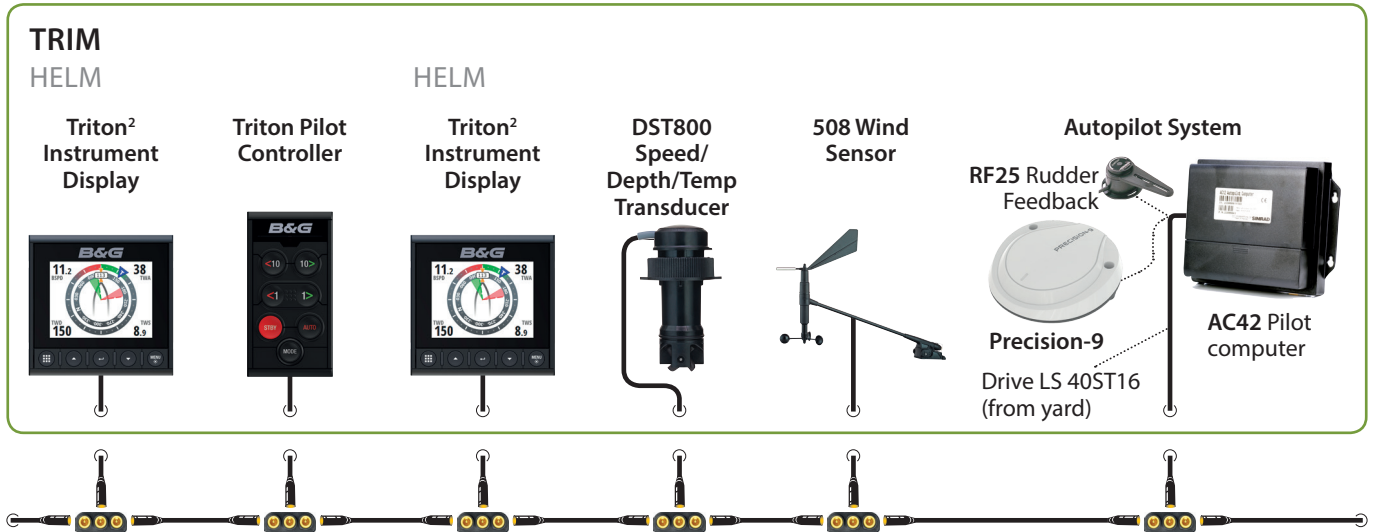

LAGOON 450 SPORTOP / OPTIONS

OPTIONAL WIFI

WIFI-1™: Wireless Module
 • Free "GoFree" application to view/control the MFD available from web



OPTIONAL VHF

V50 VHF Radio
 • includes AIS receiver



OPTIONAL VHF 2ND UNIT

H50 Wireless Handset



OPTIONAL AIS

NAIS400 AIS Transponder



OPTIONS



OPTIONAL RADAR

Broadband Radar 4G



OPTIONAL REMOTE

WR10 Wireless Autopilot Remote



OPTIONAL MFD - CHART

Zeus² 12" wide
 • 12" LED Multifunction Colour/ Touch display
 • Navionics regional cartography included (on SDcard)
 • Integrated Pilot control (optional)



OPTIONAL MFD - HELM

Zeus² 12" wide
 • 12" LED Multifunction Colour/ Touch display
 • Navionics regional cartography included (on SDcard)
 • Integrated Pilot control (optional)



OPTIONAL ZEUS MODULES

SonarHub™

ForwardScan®



OPTIONAL CONTROL

QS 80 Joystick



LAGOON 450 FLYBRIDGE

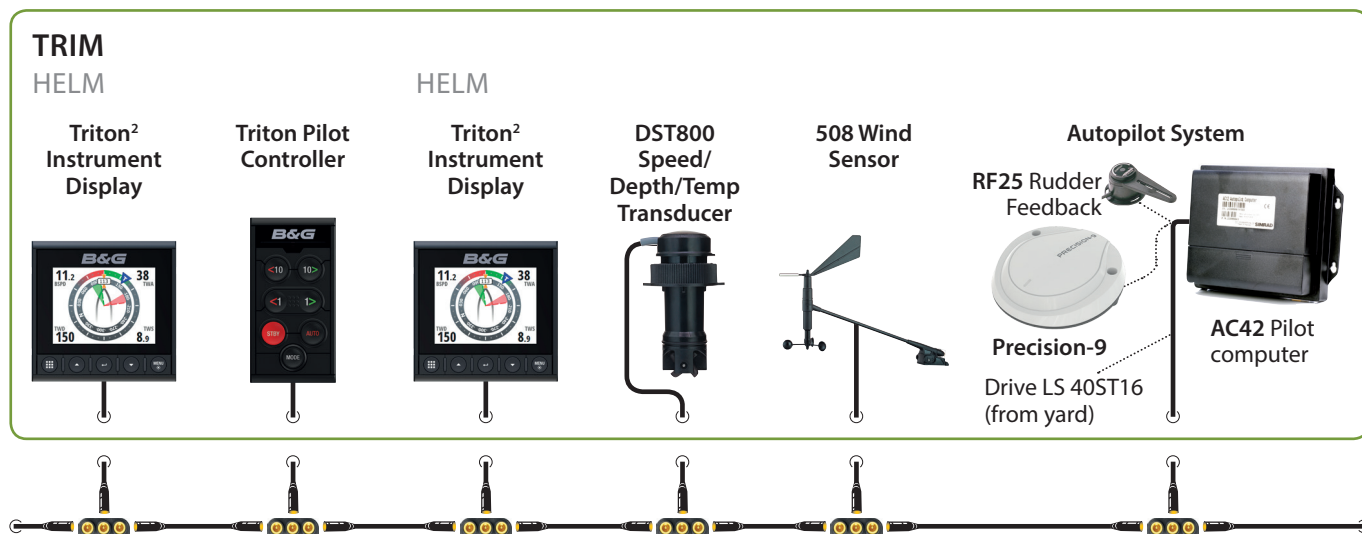

LAGOON 450 FLYBRIDGE / OPTIONS

<p>OPTIONAL WIFI</p> <p>WIFI-1™: Wireless Module</p> <ul style="list-style-type: none"> Free "GoFree" application to view/control the MFD available from web  <p>Ethernet</p>	<p>OPTIONAL VHF</p> <p>V50 VHF Radio</p> <ul style="list-style-type: none"> includes AIS receiver 	<p>OPTIONAL VHF 2ND UNIT</p> <p>H50 Wireless Handset</p> 	<p>OPTIONAL AIS</p> <p>NAIS400 AIS Transponder</p> 
<p>OPTIONS</p> 			
<p>OPTIONAL RADAR</p> <p>Broadband Radar 4G</p>  <p>Ethernet</p>	<p>OPTIONAL REMOTE</p> <p>WR10 Wireless Autopilot Remote</p> 	<p>OPTIONAL MFD - CHART</p> <p>Zeus² 12" wide</p> <ul style="list-style-type: none"> 12" LED Multifunction Colour/ Touch display Navionics regional cartography included (on SDcard) Integrated Pilot control (optional) 	<p>OPTIONAL MFD - HELM</p> <p>Zeus² 12" wide</p> <ul style="list-style-type: none"> 12" LED Multifunction Colour/ Touch display Navionics regional cartography included (on SDcard) Integrated Pilot control (optional) 
			
<p>OPTIONAL ZEUS MODULES</p> <p>SonarHub™ ForwardScan®</p>  <p>Ethernet FORWARDSCAN®</p>	<p>OPTIONAL CONTROL</p> <p>QS 80 Joystick</p> 	<p>OPTIONAL 2 CAMERAS</p> <p>Navcams & Video Splitter</p>  <p>NavCam (rear) NavCam (engine)</p> <p>RCA</p>	
			

LAGOON 52 SPORTOP

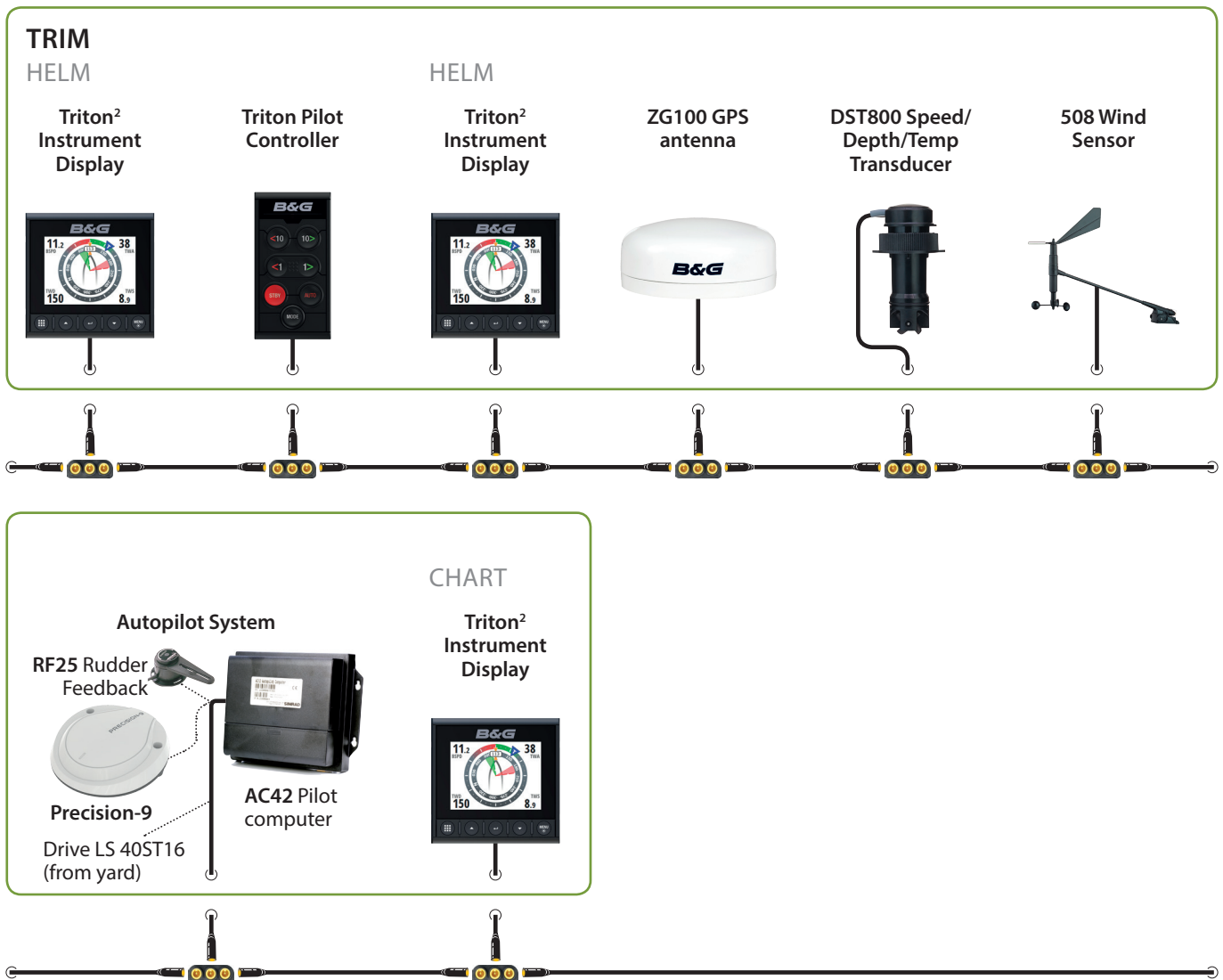

LAGOON 52 SPORTOP / OPTIONS

<p>OPTIONAL HELM</p> <p>ZM 16 16" touch screen</p>  <p>Zeus² black box • Navionics regional cartography included</p> 	<p>OPTIONAL WIFI</p> <p>WIFI-1™: Wireless Module</p> <ul style="list-style-type: none"> Free "GoFree" application to view/control the MFD available from web  <p>Ethernet</p>	<p>OPTIONAL CHART</p> <p>ZM 16 16" touch screen</p> 	<p>OPTIONAL AIS</p> <p>NAIS400 AIS Transponder</p> 
<p>OPTIONS</p> 			
<p>OPTIONAL VHF 2ND UNIT</p> <p>V90 VHF System and H50 Wireless Handset</p> 	<p>OPTIONAL ZEUS MODULES</p> <p>SonarHub™</p>  <p>Ethernet</p> <p>ForwardScan®</p>  <p>FORWARDSCAN®</p>	<p>OPTIONAL ZEUS MODULES</p> <p>SonarHub™ & Bronze HDI Transducer 50/200/455/800</p>  <p>DOWNSCAN IMAGING™</p> <p>Ethernet</p>	
			
<p>OPTIONAL REMOTE</p> <p>WR10 Wireless Autopilot Remote</p> 	<p>OPTIONAL RADAR</p> <p>Broadband Radar 4G</p>  <p>Ethernet</p>	<p>OPTIONAL CONTROL</p> <p>QS 80 Joystick</p> 	<p>OPTIONAL THERMAL CAMERA PACK*</p> <p>ZC2 Remote</p>  <p>Thermal Camera (M324XP)</p>  <p>RCA</p> <p>Video Splitter</p>  <p>RCA</p>
			

* Thermal pack requires MFD at chart table.

LAGOON 52 FLYBRIDGE

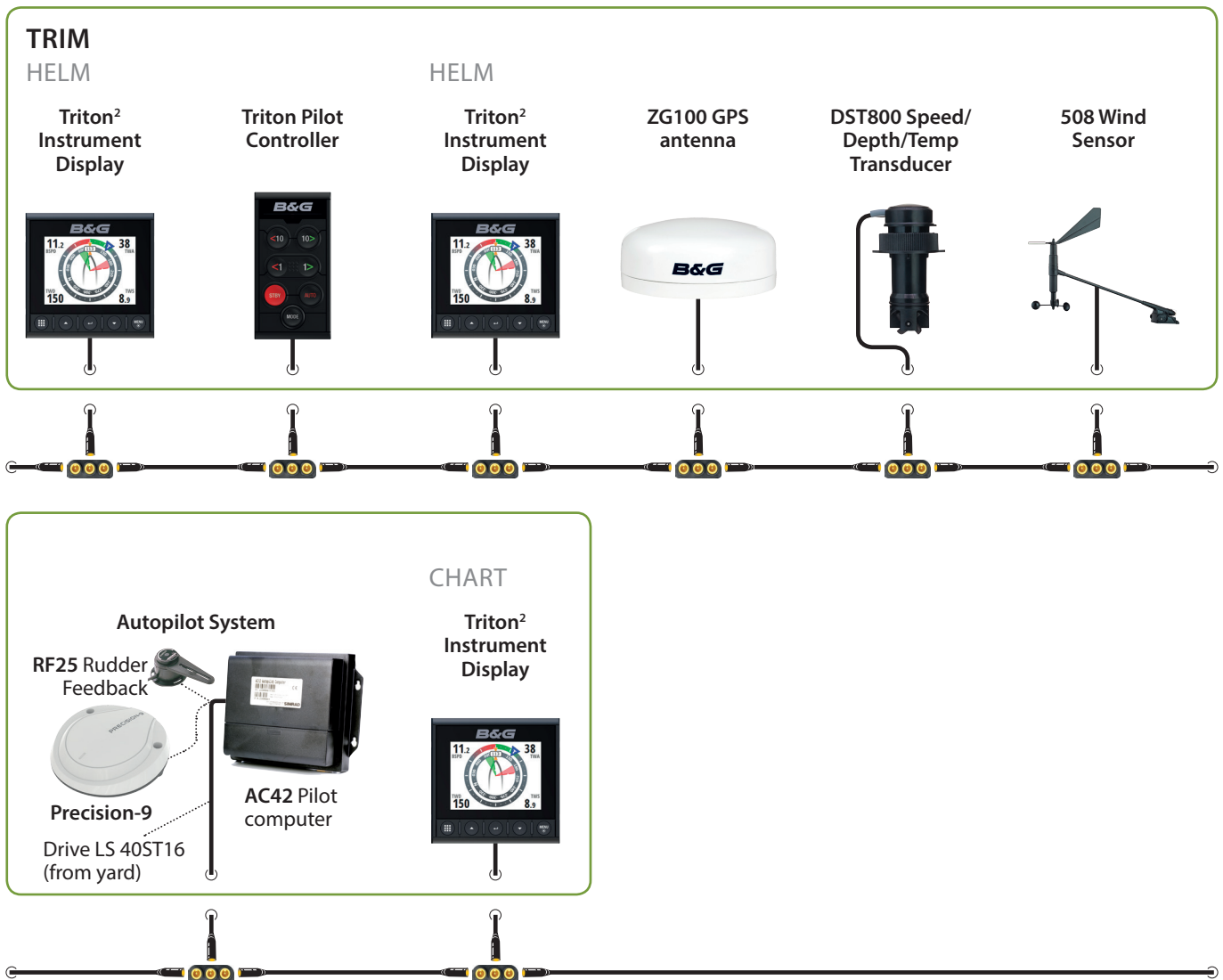

LAGOON 52 FLYBRIDGE / OPTIONS

<p>OPTIONAL HELM</p> <p>ZM 16 16" touch screen</p> <p>Zeus² black box • Navionics regional cartography included</p>	<p>OPTIONAL WIFI</p> <p>WIFI-1™: Wireless Module</p> <ul style="list-style-type: none"> Free "GoFree" application to view/control the MFD available from web <p>Ethernet</p>	<p>OPTIONAL CHART</p> <p>ZM 16 16" touch screen</p>	<p>OPTIONAL AIS</p> <p>NAIS400 AIS Transponder</p>
<p>OPTIONS</p>			
<p>OPTIONAL VHF 2ND UNIT</p> <p>V90 VHF System and H50 Wireless Handset</p>	<p>OPTIONAL ZEUS MODULES</p> <p>SonarHub™ ForwardScan®</p> <p>Ethernet</p> <p>FORWARDSCAN®</p>	<p>OPTIONAL ZEUS MODULES</p> <p>SonarHub™ & Bronze HDI Transducer 50/200/455/800</p> <p>DOWNSCAN IMAGING™</p> <p>Ethernet</p>	<p>OPTIONAL REMOTE</p> <p>WR10 Wireless Autopilot Remote</p>
<p>OPTIONAL RADAR</p> <p>Broadband Radar 4G</p> <p>Ethernet</p>	<p>OPTIONAL CONTROL</p> <p>QS 80 Joystick</p>	<p>OPTIONAL THERMAL CAMERA PACK*</p> <p>ZC2 Remote</p> <p>Thermal Camera (M324XP)</p> <p>Video Splitter</p> <p>RCA</p> <p>RCA</p>	<p>OPTIONAL 2 CAMERAS</p> <p>Navcams & Video Splitter</p> <p>RCA</p>

* Thermal pack requires MFD at chart table.

LAGOON 560

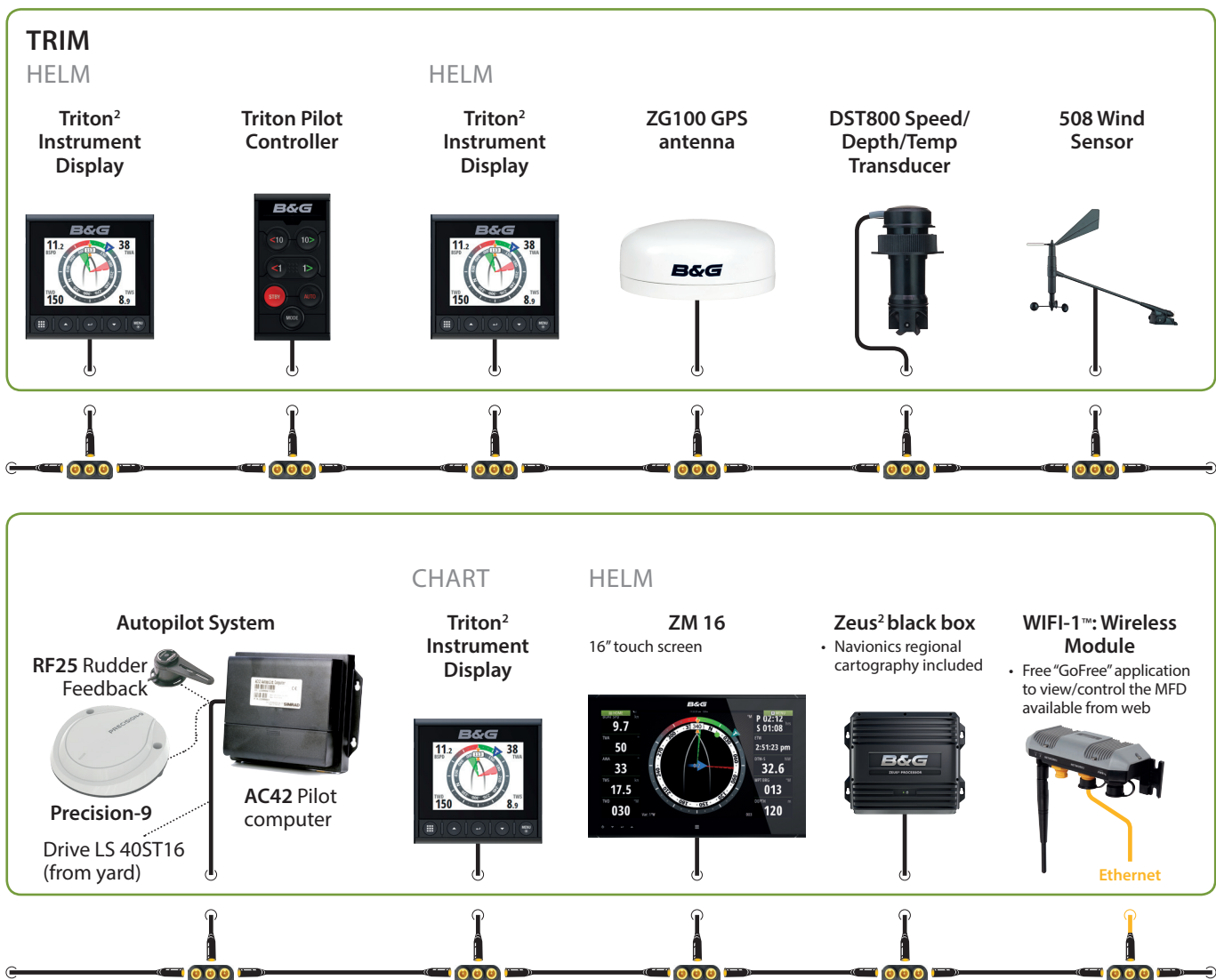

LAGOON 560 / OPTIONS

<p>OPTIONAL CHART</p> <p>ZM 16 16" touch screen</p>  <p>ZC2 Remote</p> 	<p>OPTIONAL VHF 2ND UNIT</p> <p>V90 VHF System and H50 Wireless Handset</p> 	<p>OPTIONAL AIS</p> <p>NAIS400 AIS Transponder</p> 	
<p>OPTIONS</p> 			
<p>OPTIONAL RADAR</p> <p>Broadband Radar 4G</p>  <p>Ethernet</p>	<p>OPTIONAL ZEUS MODULES</p> <p>SonarHub™</p>  <p>Ethernet</p> <p>ForwardScan®</p>  <p>FORWARDSCAN®</p>	<p>OPTIONAL ZEUS MODULES</p> <p>SonarHub™ & Bronze HDI Transducer 50/200/455/800</p>  <p>DOWNSCAN IMAGING™</p> <p>Ethernet</p>	
			
<p>OPTIONAL REMOTE</p> <p>WR10 Wireless Autopilot Remote</p> 	<p>OPTIONAL CONTROL</p> <p>QS 80 Joystick</p> 	<p>OPTIONAL THERMAL CAMERA PACK*</p> <p>Thermal Camera (M324XP)</p>  <p>RCA</p> <p>Video Splitter</p>  <p>RCA</p>	<p>OPTIONAL 2 CAMERAS</p> <p>Navcams & Video Splitter</p>  <p>NavCam (rear) NavCam (engine)</p>  <p>RCA</p>
			

* Thermal pack requires MFD at chart table.

LAGOON 620

TRIM

HELM PORT

POD

HELM STARBOARD

Graphic Display H5000

H5000 Triton Pilot Controller

ZM 16 16" touch screen

Zeus² black box

20/20 Displays

ZM 16 16" touch screen

H5000 Triton Pilot Controller

Graphic Display H5000



CHART

SENSPD (Speed) H5000 Transducer

ZM 16 16" touch screen

H5000 Triton Pilot Controller

Zeus² black box

WIFI-1™: Wireless Module

- Free "GoFree" application to view/control the MFD available from web

DT800 Depth/Temp Transducer

MHU 213 Wind Vane



Autopilot System

RF25 Rudder Feedback



Precision-9 Drive LS 40ST16 (from yard)

Pilot Computer H5000

H5000 Hydra CPU



LAGOON 620 / OPTIONS

<p>OPTIONAL UPGRADE SIZE</p> <p>ZM 19 19" touch screen</p>	<p>OPTIONAL VHF 2ND UNIT</p> <p>V90 VHF System and H50 Wireless Handset</p>	<p>OPTIONAL AIS</p> <p>NAIS400 AIS Transponder</p>	
<p>OPTIONS</p>			
<p>OPTIONAL RADAR</p> <p>Broadband Radar 4G</p> <p>Ethernet</p>	<p>OPTIONAL ZEUS MODULES</p> <p>SonarHub™</p> <p>ForwardScan®</p> <p>Ethernet</p> <p>FORWARDSCAN®</p>	<p>OPTIONAL ZEUS MODULES</p> <p>SonarHub™ & Bronze HDI Transducer 50/200/455/800</p> <p>DOWNSCAN IMAGING™</p> <p>Ethernet</p>	
<p>OPTIONAL REMOTE</p> <p>WR10 Wireless Autopilot Remote</p>	<p>OPTIONAL CONTROL</p> <p>QS 80 Joystick</p>	<p>OPTIONAL THERMAL CAMERA PACK*</p> <p>ZC2 Remote</p> <p>Thermal Camera (M324XP)</p> <p>Video Splitter</p> <p>RCA</p> <p>RCA</p>	<p>OPTIONAL 2 CAMERAS</p> <p>Navcams & Video Splitter</p> <p>NavCam (rear)</p> <p>NavCam (engine)</p> <p>RCA</p>

* Thermal pack requires MFD at chart table.